

How to apply a Ninja Plus Tag with a Plastic Backing

Figure 1

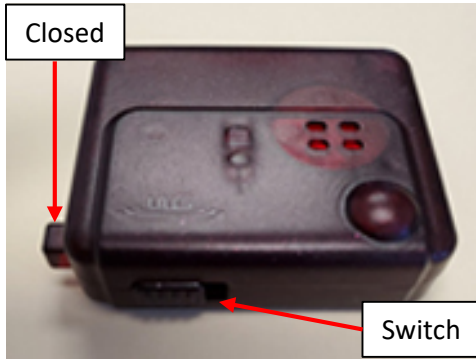

If the lock is closed as shown above please open it (see Fig 2).

Figure 2



Place the tag on the detacher and push in the tab to open/disarm.

Figure 3



The tag is opened/disarmed and ready to be closed/armed.

Figure 4



Peel off the paper to expose the sticky side of the plastic backing.

Figure 5



Place the plastic backing on the package, pressing down firmly by rubbing the backing all over with your finger making sure there are no air bubbles. Wait 2 minutes before applying the tag.

Figure 6



Place the tag into the plastic backing, then slide the switch to arm. A beep will sound to indicate the tag is armed and protecting the package.