

How to apply a Ninja Plus Tag with Foam a Backing

Fig 1

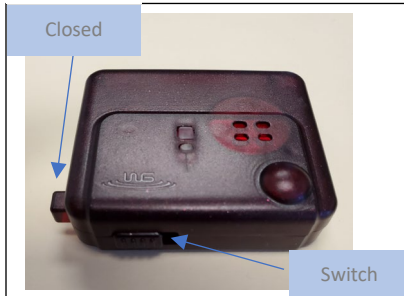

If the lock is closed see above please open it see Fig 2

Fig 2

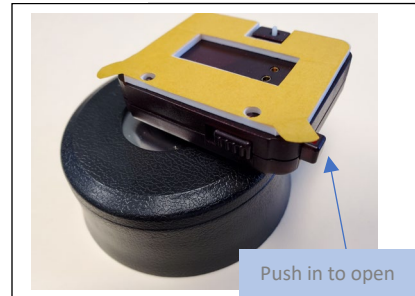

Place the tag on the detacher push in the tab to open/ disarm.

Fig 3



The tag is open/disarmed and ready to be closed/armed.

Fig 4



Place the foam backing on the tag press down firmly.

Fig 5



Peel off the paper to expose the foams sticky side.

Fig 6

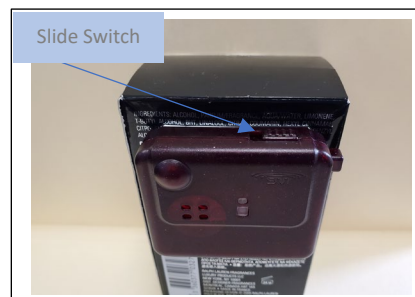

Place the tag on the packaging, then slide the switch to arm. A beep will sound to indicate the tag is armed and protecting the package.

How to apply a Ninja Plus Tag with a Plastic Backing

Fig 1

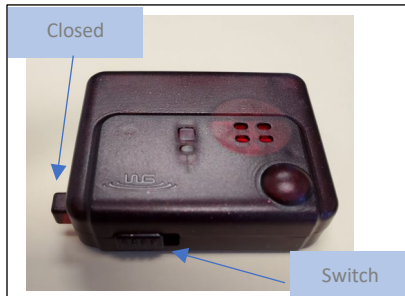

If the lock is closed see above please open it see Fig 2

Fig 2



Place the tag on the detacher push in the tab to open/ disarm.

Fig 3



The tag is open/disarmed and ready to be closed/armed.

Fig 4

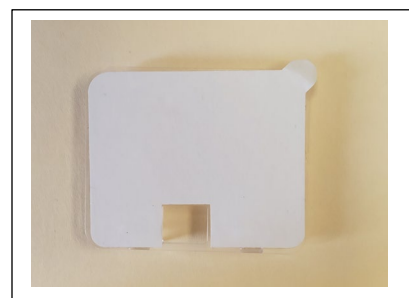

Peel off the paper to expose the sticky side of the plastic backing.

Fig 5

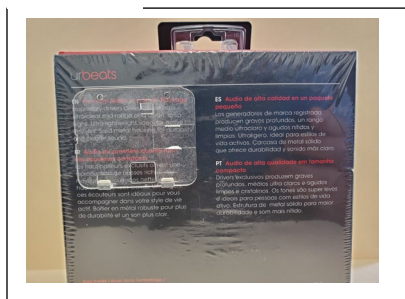

Place the plastic backing on the package, press down firmly by rubbing the backing all over with your finger making sure there are no air bubbles. Apply tag after 2 minutes.

Fig 6

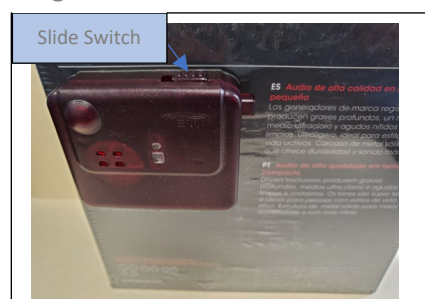

Place the tag in the plastic backing, then slide the switch to arm. A beep will sound to indicate the tag is armed and protecting the package.